

SLIP RINGS (RING COLLECTORS)

- 42mm Through hole passage | Vertical Axis
- Copper-Graphite Brushes
- Cable entry through PG21
- Conforms to EN60947-5-1, EN60529

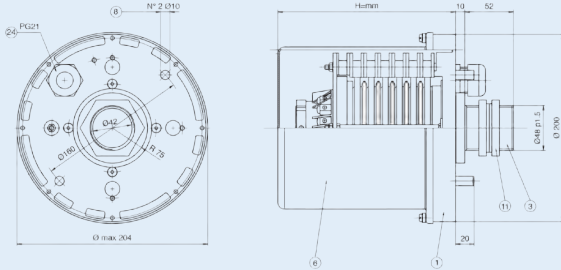

PRS Series IP55 - Standard Type - Aluminium Housing

Code	No Rings - 20A	No Rings - 30A	Size - (Ø x H)mm
GPRSC4	-	4	180 x 192
GPRSC6	-	6	180 x 192
GPRSC8	-	8	180 x 252
GPRSC10	-	10	180 x 252
GPRSC12	-	12	180 x 312

PRS Series IP55 - Mixed Ring Type - Aluminium Housing

Code	No Rings - 20A	No Rings - 30A	Size - (Ø x H)mm
GPRSC4/B7	7	4	180 x 282
GPRSC4/B8	8	4	180 x 312
GPRSC4/B9	9	4	180 x 342

- Nominal Voltage: 660VAC/DC
- Test Voltage: 2.5kV
- Nominal Current (Ith): 20A - 30A (See Code)
- Operating Temperature: -20°C to 60°C
- Max Rotating Speed: 30RPM

- 42mm Through hole passage | Vertical Axis
- Copper-Graphite Brushes
- Cable entry through PG21
- Cable entry on both flanges
- Conforms to EN60947-5-1, EN60529

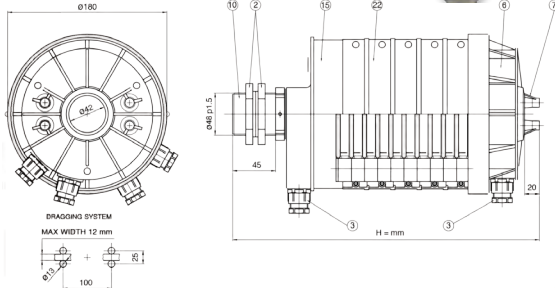

PRP Series IP51 - Standard Type - Thermoplastic Insulated Housing

Code	No Rings - 20A	No Rings - 30A	Size - (Ø x H)mm
GPRPC4	-	4	180 x 260
GPRPC6	-	6	180 x 290
GPRPC8	-	8	180 x 320
GPRPC10	-	10	180 x 350
GPRPC12	-	12	180 x 380

PRP Series IP51 - Mixed Ring Type - Thermoplastic Insulated Housing

Code	No Rings - 20A	No Rings - 30A	Size - (Ø x H)mm
GPRPC4/B2	2	4	180 x 290
GPRPC4/B4	4	4	180 x 320
GPRPC4/B6	6	4	180 x 350

- Nominal Voltage: 660VAC/DC
- Test Voltage: 2.5kV
- Nominal Current (Ith): 20A - 30A (See Code)
- Operating Temperature: -20°C to 60°C
- Max Rotating Speed: 30RPM

WORM DRIVE LIMIT SWITCHES IP65

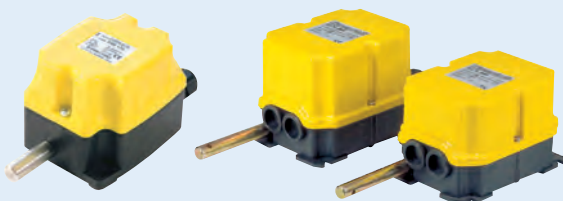

BFRS Type

BFCN-TYPE

CAM TYPES

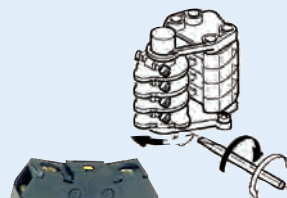
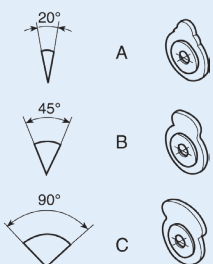

FCN-APINT

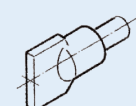

FCN-INNFC

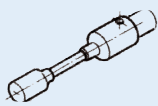

FCN-AFLESFC



FCN-POT

FRS/FCN Type - with failsafe positive opening microswitches

Ratio	Code 2 Contacts	Code 4 Contacts
1:25	BFRS25R2	BFRS25R4
1:50	BFRS50R2	BFRS50R4
1:100	BFRS100R2	BFRS100R4
1:150	BFRS150R2	BFRS150R4
1:175	BFRS175R2	BFRS175R4
1:200	BFCN200P2	BFCN200P4
1:400	BFCN400P2	BFCN400P4

Accessories

For BFCN	For BFRS	Description
-	FRS-R	Microswitch N/C 230V 10A (Standard for BFRS)
FCN-APINT	-	Microswitch N/C 230V 10A (Standard for BFCN)
FCN-DINT	-	Microswitch with deviation contacts 230V 10A
FCN-LEVA	FRS-LEVA	20° Tripping angle cam Type A
FCN-LEVB	FRS-LEVB	45° Tripping angle cam Type B
FCN-LEVC	FRS-LEVC	90° Tripping angle cam Type C
FCN-INNFC	FCN-INNFC	Male connection
FCN-AFLESFC	FCN-AFLESFC	Flexible shaft
FCN-POT	FRS-POT*	10kΩ pot & mounting kit

*BFRS Type switches can accommodate either the contacts or potentiometer, not both.