

ECHO-PIEZO BUZZER

B18 SERIES

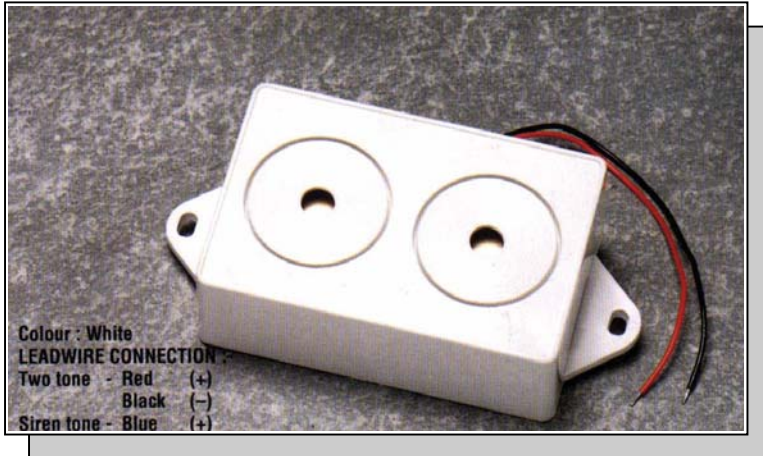

FEATURES:

- Two/Siren/Dual tone
- Scaring loudness
- Rigid construction
- Screw mounting
- Operating temperature -20°C --- $+70^{\circ}\text{C}$
- Storage temperature -30°C --- $+70^{\circ}\text{C}$

DIMENSIONS:

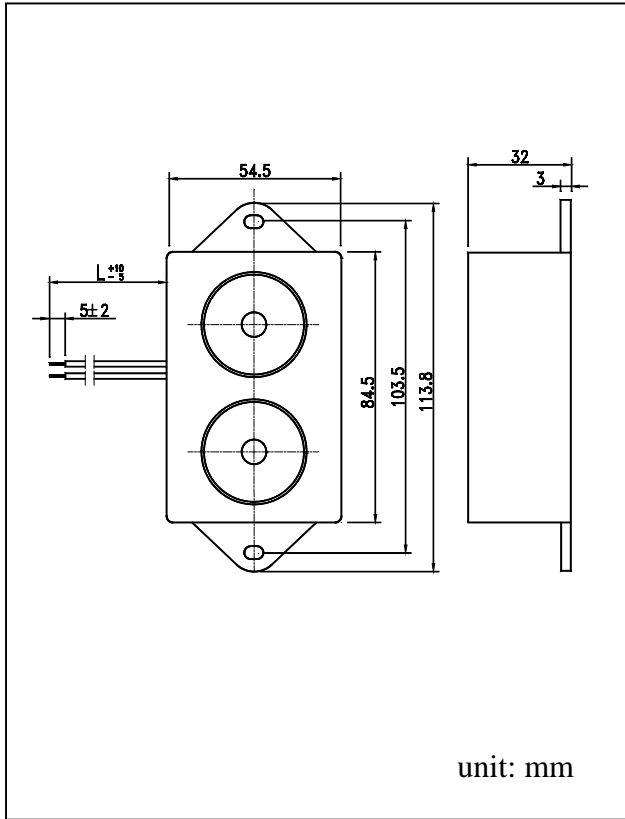

CHARACTERISTICS:

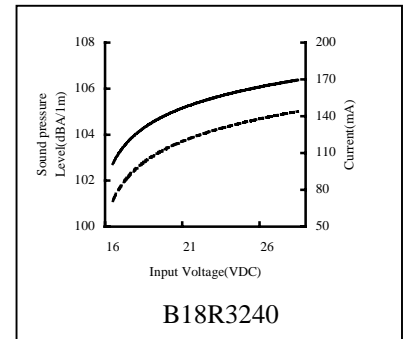
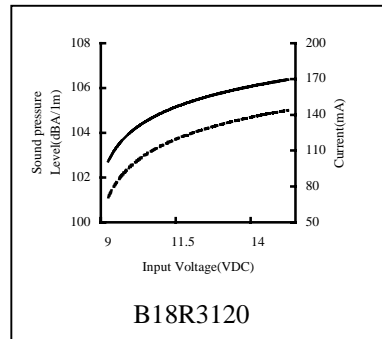
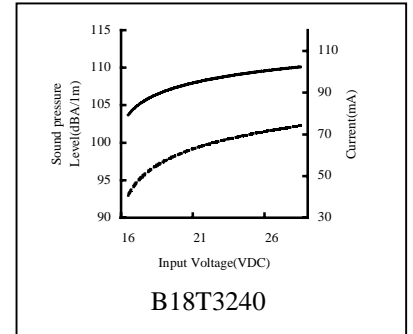
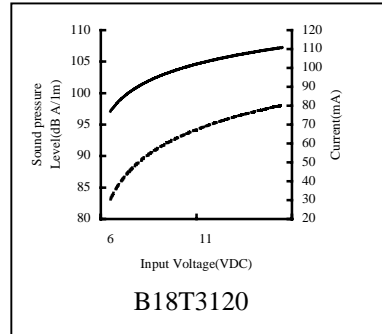

Remark: ——— Pressure level - - - - - Current
 L=140mm, standard (changes as your request)

SPECIFICATIONS:

Model No.	Operating Voltage (VDC)	Rated Voltage (VDC)	Max. Current at Rated Voltage (mA)	Frequency (kHz)	Min. Sound Pressure at Rated Voltage (dBA/1m)	Pulse Rate at Rated Voltage (Pulse/Sec)	Tone	Terminal
B18T3120L	6-15	12	90	$(2.6-2.8)\pm 0.5$	105	0	TWO	LEAD
B18T3240L	16-28	24	120	$(2.6-2.8)\pm 0.5$	105	0	TWO	LEAD
B18R3120L	9-15	12	120	1.5-3.1	105	0	SIREN	LEAD
B18R3240L	16-28	24	120	1.5-3.1	105	0	SIREN	LEAD
B18D3120P	6-15	12	80	3.0 ± 0.5	100	0	R/P/S	Pin/Screw