



SPECIFICATION SHEET



SURGE PLUGTOP- LP600(M-10S)

- ◆ HIGH SURGE HANDLING CAPACITY
- ◆ ECONOMICAL SECONDARY PROTECTION
- ◆ DIFFERENTIAL AND COMMON MODE PROTECTION
- ◆ THERMAL AND OVERCURRENT FUSING
- ◆ PROTECTION BETWEEN L-N, L-E AND N-E PLUS WIRING CHECK

TECHNICAL OVERVIEW

RATED VOLTAGE	230V/50Hz
INPUT CONNECTORS	16a 3Pin PLUG
MAX CONTINUOUS CURRENT	16A
MAX SURGE CURRENT	8KA L-N, L-E, N-E
DIMENSIONS	57x50.1x34.5
TEMPERATURE RANG	-10°C TO 70°C
FUSING	INTERGRATED 104°C THERMAL AND 16A OVER CURRENT FUSING
MAX CONTINUOUS OPERAT-	275VaC

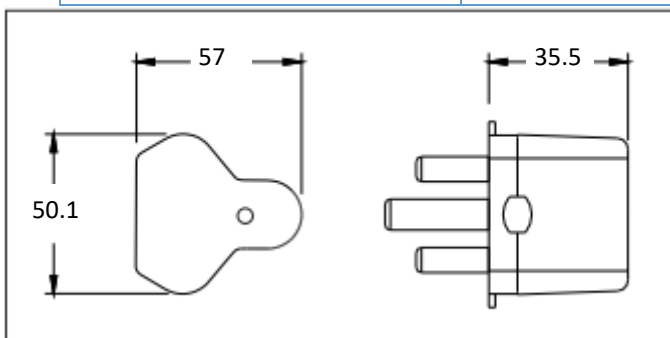

Surge plugs are used for the secondary protection of computers, video equipment, TV, alarms and other electronic equipment. They are available in the dedicated 16A round pin.

These plugs are fitted with an overcurrent and thermal fuse. In the rare event of varistor failure, the varistors are disconnected from the mains supply, preventing any dangerous temperature rise. The fault indication LED which is normally lit will go OFF to indicate the faulty protection has been disconnected. Mains power will still be available to the unprotected equipment.